

# Standard Industrial In Line Venturi Scrubber

VentilationComponents.com's  
in line venturi scrubbers are  
durable and cost effective.



## Application

- Use to remove contaminants from an airstream
- Various sizes available
- Pressure ratings ranging from 15inWC to 50inWC, with higher pressure ratings up to 100inWC available upon request

## Features

- Adjustable venturi throat
- Bolted inspection plate with handle
- Flanged piping connections

## Benefits

- Simple, reliable, and easy to maintain
- Heavy duty construction

## Function

- Relatively dry air with contaminants enters the inlet and accelerates through the venturi throat
- Water enters and breaks into a fine mist when exposed to the air stream
- The contaminants collide with the water droplets and become encapsulated

## Options

### Size

Sizes ranging from 8.00in to 60.00in inside flange diameter are available. Larger sizes are available upon request.

### Pressure rating

Three different pressure ratings are offered: 15inWC, 30inWC, and 50inWC. Custom pressure ratings up to 100inWC are available upon request.

### Rotation

The unit can be built with a clockwise or counterclockwise rotation.

### Efficiency Rate

The efficiency of the scrubber is application dependent and is provided during the ordering stage.

### Materials

The materials offered suit a variety of different applications.

#### Primary material

- 316 stainless steel

#### Gasket material

- EPDM

#### Hardware material

- 316 stainless steel

Other materials not listed are available upon request.

### Flange bolt pattern

The flange bolt patterns follow our standard. Different patterns are available upon request.

### Data and dimensions

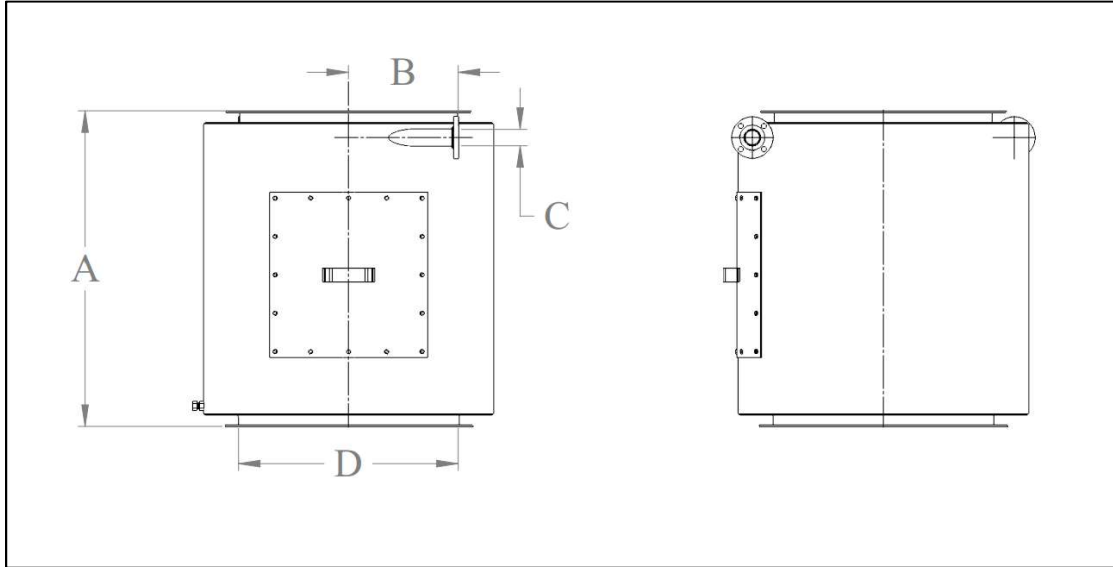

Item Number	"D"	Nominal	Nominal	Required Flow	"A"	"B"	"C"
	Nominal Tank	Capacity	Pressure		Length	Shower Pipe	Shower Pipe
	Size		Rating	Rate		Length	Size
	inches	cfm	inWC	USGPM	inches	inches	nominal pipe
VS-02-8-15	8.00	1,400	15	14	30.00	6.00	P0.75
VS-02-8-30	8.00	1,400	30	14	30.00	6.00	P0.75
VS-02-8-50	8.00	1,400	50	14	30.00	6.00	P0.75
VS-02-10-15	10.00	2,200	15	22	31.00	7.00	P0.75
VS-02-10-30	10.00	2,200	30	22	31.00	7.00	P0.75
VS-02-10-50	10.00	2,200	50	22	31.00	7.00	P0.75
VS-02-12-15	12.00	3,100	15	31	32.50	8.00	P0.75
VS-02-12-30	12.00	3,100	30	31	32.50	8.00	P0.75
VS-02-12-50	12.00	3,100	50	31	32.50	8.00	P0.75
VS-02-14-15	14.00	4,300	15	43	33.50	9.00	P1
VS-02-14-30	14.00	4,300	30	43	33.50	9.00	P1
VS-02-14-50	14.00	4,300	50	43	33.50	9.00	P1
VS-02-16-15	16.00	5,600	15	56	35.00	10.00	P1
VS-02-16-30	16.00	5,600	30	56	35.00	10.00	P1
VS-02-16-50	16.00	5,600	50	56	35.00	10.00	P1
VS-02-18-15	18.00	7,100	15	71	36.00	11.00	P1
VS-02-18-30	18.00	7,100	30	71	36.00	11.00	P1
VS-02-18-50	18.00	7,100	50	71	36.00	11.00	P1
VS-02-20-15	20.00	8,700	15	87	37.50	12.00	P1
VS-02-20-30	20.00	8,700	30	87	37.50	12.00	P1
VS-02-20-50	20.00	8,700	50	87	37.50	12.00	P1
VS-02-22-15	22.00	10,600	15	106	38.50	13.00	P1
VS-02-22-30	22.00	10,600	30	106	38.50	13.00	P1
VS-02-22-50	22.00	10,600	50	106	38.50	13.00	P1
VS-02-24-15	24.00	12,600	15	126	40.00	14.00	P1.5
VS-02-24-30	24.00	12,600	30	126	40.00	14.00	P1.5
VS-02-24-50	24.00	12,600	50	126	40.00	14.00	P1.5
VS-02-26-15	26.00	14,700	15	147	41.00	15.00	P1.5
VS-02-26-30	26.00	14,700	30	147	41.00	15.00	P1.5
VS-02-26-50	26.00	14,700	50	147	41.00	15.00	P1.5
VS-02-28-15	28.00	17,100	15	171	42.25	16.00	P1.5
VS-02-28-30	28.00	17,100	30	171	42.25	16.00	P1.5
VS-02-28-50	28.00	17,100	50	171	42.25	16.00	P1.5
VS-02-30-15	30.00	19,600	15	196	43.50	17.00	P1.5
VS-02-30-30	30.00	19,600	30	196	43.50	17.00	P1.5
VS-02-30-50	30.00	19,600	50	196	43.50	17.00	P1.5
VS-02-32-15	32.00	22,300	15	223	45.00	18.00	P2
VS-02-32-30	32.00	22,300	30	223	45.00	18.00	P2
VS-02-32-50	32.00	22,300	50	223	45.00	18.00	P2

Item Number	"D" Nominal Tank Size	Nominal Capacity	Nominal Pressure Rating	Required Flow Rate	"A" Length	"B" Shower Pipe Length	"C" Shower Pipe Size
	inches	cfm	inWC	USGPM	inches	inches	nominal pipe
VS-02-34-15	34.00	25,200	15	252	48.00	19.00	P2
VS-02-34-30	34.00	25,200	30	252	48.00	19.00	P2
VS-02-34-50	34.00	25,200	50	252	48.00	19.00	P2
VS-02-36-15	36.00	28,300	15	283	51.25	20.00	P2
VS-02-36-30	36.00	28,300	30	283	51.25	20.00	P2
VS-02-36-50	36.00	28,300	50	283	51.25	20.00	P2
VS-02-38-15	38.00	31,500	15	315	54.00	21.00	P2
VS-02-38-30	38.00	31,500	30	315	54.00	21.00	P2
VS-02-38-50	38.00	31,500	50	315	54.00	21.00	P2
VS-02-40-15	40.00	34,900	15	349	58.25	22.00	P2
VS-02-40-30	40.00	34,900	30	349	58.25	22.00	P2
VS-02-40-50	40.00	34,900	50	349	58.25	22.00	P2
VS-02-42-15	42.00	38,500	15	385	61.50	23.00	P2
VS-02-42-30	42.00	38,500	30	385	61.50	23.00	P2
VS-02-42-50	42.00	38,500	50	385	61.50	23.00	P2
VS-02-44-15	44.00	42,200	15	422	64.00	24.00	P2
VS-02-44-30	44.00	42,200	30	422	64.00	24.00	P2
VS-02-44-50	44.00	42,200	50	422	64.00	24.00	P2
VS-02-46-15	46.00	46,100	15	461	68.00	25.00	P2.5
VS-02-46-30	46.00	46,100	30	461	68.00	25.00	P2.5
VS-02-46-50	46.00	46,100	50	461	68.00	25.00	P2.5
VS-02-48-15	48.00	50,200	15	502	72.00	26.00	P2.5
VS-02-48-30	48.00	50,200	30	502	72.00	26.00	P2.5
VS-02-48-50	48.00	50,200	50	502	72.00	26.00	P2.5
VS-02-50-15	50.00	54,500	15	545	76.25	27.00	P2.5
VS-02-50-30	50.00	54,500	30	545	76.25	27.00	P2.5
VS-02-50-50	50.00	54,500	50	545	76.25	27.00	P2.5
VS-02-52-15	52.00	59,000	15	590	81.25	28.00	P2.5
VS-02-52-30	52.00	59,000	30	590	81.25	28.00	P2.5
VS-02-52-50	52.00	59,000	50	590	81.25	28.00	P2.5
VS-02-54-15	54.00	63,600	15	636	86.50	29.00	P2.5
VS-02-54-30	54.00	63,600	30	636	86.50	29.00	P2.5
VS-02-54-50	54.00	63,600	50	636	86.50	29.00	P2.5
VS-02-56-15	56.00	68,400	15	684	93.00	30.00	P3
VS-02-56-30	56.00	68,400	30	684	93.00	30.00	P3
VS-02-56-50	56.00	68,400	50	684	93.00	30.00	P3
VS-02-58-15	58.00	73,400	15	734	95.25	31.00	P3
VS-02-58-30	58.00	73,400	30	734	95.25	31.00	P3
VS-02-58-50	58.00	73,400	50	734	95.25	31.00	P3
VS-02-60-15	60.00	78,500	15	785	101.00	32.00	P3
VS-02-60-30	60.00	78,500	30	785	101.00	32.00	P3
VS-02-60-50	60.00	78,500	50	785	101.00	32.00	P3

Notes

1. 3D model files and general arrangement drawings with installation details available upon order.
2. Clockwise rotation shown.

### Standard round flange details

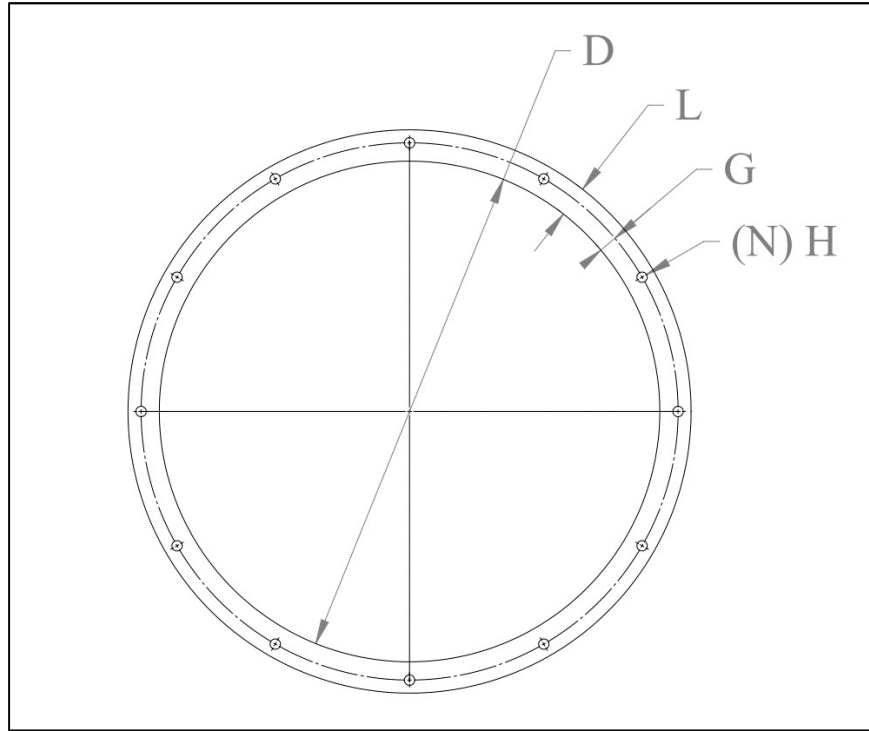

"D" Nominal Size		"L" Flange Leg	"G" Gauge	"N" Number of Holes	"H" Hole Diameter	Bolt Size
D <sub>LOWER</sub> inches	D <sub>UPPER</sub> inches					
0	8.00	1.50	0.875	4	0.500	3/8
8.01	16.00	1.50	0.875	8	0.500	3/8
16.01	24.00	1.50	0.875	12	0.500	3/8
24.01	31.00	1.50	0.875	16	0.500	3/8
31.01	39.00	2.00	1.125	20	0.500	3/8
39.01	46.00	2.50	1.375	24	0.625	1/2
46.01	54.00	2.50	1.375	28	0.625	1/2
54.01	62.00	2.50	1.375	32	0.625	1/2
62.01	70.00	2.50	1.375	36	0.625	1/2
70.01	78.00	2.50	1.375	40	0.625	1/2
78.01	86.00	3.00	1.750	44	0.625	1/2
86.01	94.00	3.00	1.750	48	0.625	1/2
94.01	101.00	3.00	1.750	52	0.625	1/2
101.01	108.00	4.00	2.250	56	0.625	1/2
108.01	120.00	4.00	2.250	60	0.625	1/2

Notes

1. Holes always land on centerlines.

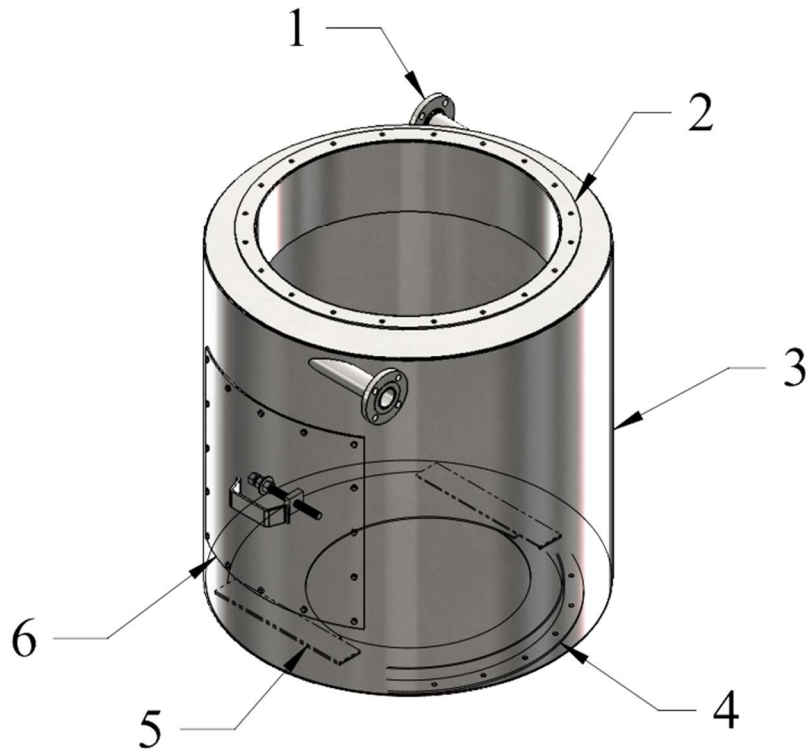

### Parts list

Number	Quantity	Description
1	2	Scrubbing water inlet connection
2	1	Air inlet
3	1	Wetted approach
4	1	Air outlet
5	1	Adjustable venturi throat
6	1	Bolted inspection plate

Notes

1. All hardware provided. Unit is assembled when delivered.

## How to order

To fully specify the VS-02 In Line Venturi Scrubber, make a selection from the code boxes below.

**Example:** VS-02-32-1-1-1-30-CCW-S, shown below, is an in line venturi scrubber with a 32.00in nominal size, 316 stainless steel as the primary material, EPDM gasket material, 316 stainless steel hardware, a 30inWC pressure rating, a counterclockwise rotation, and our standard bolt pattern.

<b>1</b>	<b>2</b>	<b>3</b>	<b>4</b>	<b>5</b>	<b>6</b>	<b>7</b>	<b>8</b>	<b>9</b>
VS	02	32	1	1	1	30	CCW	S
<b>Specifications</b>								
Please provide a drawing for our approval of the specified scrubber.								

<b>1</b>	<b>Equipment type</b>		
VS	Venturi Scrubber		
<b>2</b>	<b>Equipment sub-type</b>		
02	In Line Venturi Scrubber		
<b>3</b>	<b>Nominal size</b>		
08	Nominal ø8.00in [ø203.2mm] 1,400cfm	<b>36</b>	Nominal ø36.00in [ø914.4mm] 28,300cfm
10	Nominal ø10.00in [ø254.0mm] 2,200cfm	<b>38</b>	Nominal ø38.00in [ø965.2mm] 31,500cfm
12	Nominal ø12.00in [ø304.8mm] 3,100cfm	<b>40</b>	Nominal ø40.00in [ø1016.0mm] 34,900cfm
14	Nominal ø14.00in [ø355.6mm] 4,300cfm	<b>42</b>	Nominal ø42.00in [ø1066.8mm] 38,500cfm
16	Nominal ø16.00in [ø406.4mm] 5,600cfm	<b>44</b>	Nominal ø44.00in [ø1117.6mm] 42,200cfm
18	Nominal ø18.00in [ø457.2mm] 7,100cfm	<b>46</b>	Nominal ø46.00in [ø1168.4mm] 46,100cfm
20	Nominal ø20.00in [ø508.0mm] 8,700cfm	<b>48</b>	Nominal ø48.00in [ø1219.2mm] 50,200cfm
22	Nominal ø22.00in [ø558.8mm] 10,600cfm	<b>50</b>	Nominal ø50.00in [ø1270.0mm] 54,500cfm
24	Nominal ø24.00in [ø609.6mm] 12,600cfm	<b>52</b>	Nominal ø52.00in [ø1320.8mm] 59,000cfm
26	Nominal ø26.00in [ø660.4mm] 14,700cfm	<b>54</b>	Nominal ø54.00in [ø1371.6mm] 63,600cfm
28	Nominal ø28.00in [ø711.2mm] 17,100cfm	<b>56</b>	Nominal ø56.00in [ø1422.4mm] 68,400cfm
30	Nominal ø30.00in [ø762.0mm] 19,600cfm	<b>58</b>	Nominal ø58.00in [ø1473.2mm] 73,400cfm
32	Nominal ø32.00in [ø812.8mm] 22,300cfm	<b>60</b>	Nominal ø60.00in [ø1524.0mm] 78,500cfm
34	Nominal ø34.00in [ø863.6mm] 25,200cfm	<b>C</b>	Customer Specified Size
<b>4</b>	<b>Primary material</b>		
1	316 Stainless Steel	<b>C</b>	Customer Specified Material
<b>5</b>	<b>Gasket material</b>		
1	EPDM	<b>C</b>	Customer Specified Material
<b>6</b>	<b>Hardware material</b>		
1	316 Stainless Steel	<b>C</b>	Customer Specified Material
<b>7</b>	<b>Pressure rating</b>		
15	15inWC, Up to 700fpm	<b>50</b>	50inWC, Up to 700fpm
30	30inWC, Up to 700fpm	<b>C</b>	Customer Specified Pressure Rating
<b>8</b>	<b>Rotation</b>		
CW	Clockwise	<b>CCW</b>	Counterclockwise
<b>9</b>	<b>Flange bolt patterns</b>		
S	Standard	<b>C</b>	Customer Specified Flange Bolt Pattern

Many types of customizations are available upon request.

**Note:** There are various factors which should be considered when selecting a venturi scrubber for a specific application. Some of these factors are outside of the scope of this data sheet. If you have any questions regarding the application, compatibility, or use of this venturi scrubber, contact [VentilationComponents.com](http://VentilationComponents.com) for more information.





Contact@VentilationComponents.com